

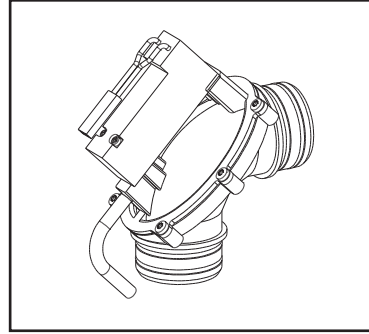

METASYS

GB ▶ **Suction stream valve, external
Installation manual**



Technical characteristics

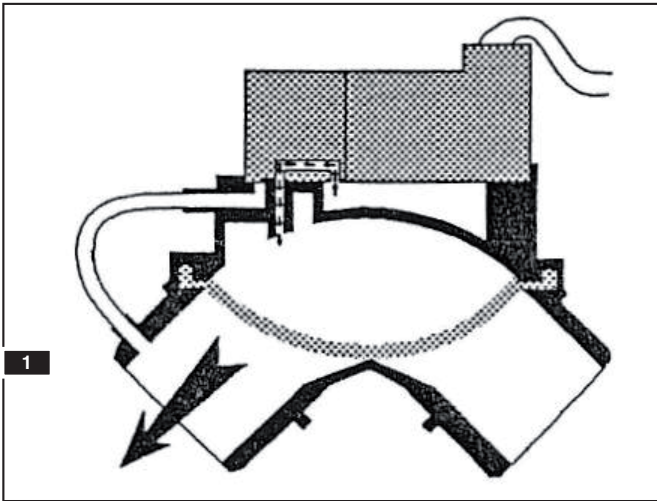

1. Use

The external suction stream valve serves as a controllable closing module for suction lines (place selection valve with central suction systems).

2. Function

1 See schematic diagram

When the solenoid valve is not activated the control channel blocks the upper side of the membrane. Through the suction stream the membrane is pulled onto the sealing face and so locks the passage.

2 See schematic diagram

When the solenoid valve is activated the passage at the upper side of the membrane is interconnected. Due to the larger surface of the upper side membrane and suction stream are released.

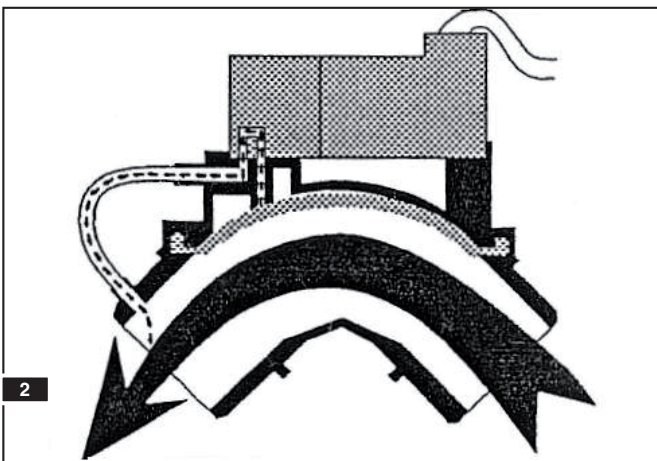

3. Technical data

Power supply:	24 V DC
Max. current consumption:	75 mA
Power:	1.8 W
Vacuum range:	0.05 bar until 0.6 bar
Dimensions (L x W x H):	73.5 x 40.6 x 63.5 mm (without adapter)
Max. required installation space:	90 x 80 x 130 mm (with 25 mm adapter)

4. Connections

3 See picture

- 3.1** Suction stream (O-ring connector for 26 mm fittings, also see section "Accessories")
Attention! Mount tube connections without tension!
- 3.2** Delivery under pressure control air (for PVC-tube $\varnothing 2 \times 1$ mm)
- 3.3** Power supply 24 V DC

The suction flow passage is possible in both directions. The control air however must always be delivered before the valve at the side of the suction motor.

When using the optional accessories (see Point 6) the under pressure delivery is already prepared in the tube fitting. The provided connections therefore are for 25 mm tubes and are 360° rotatable.

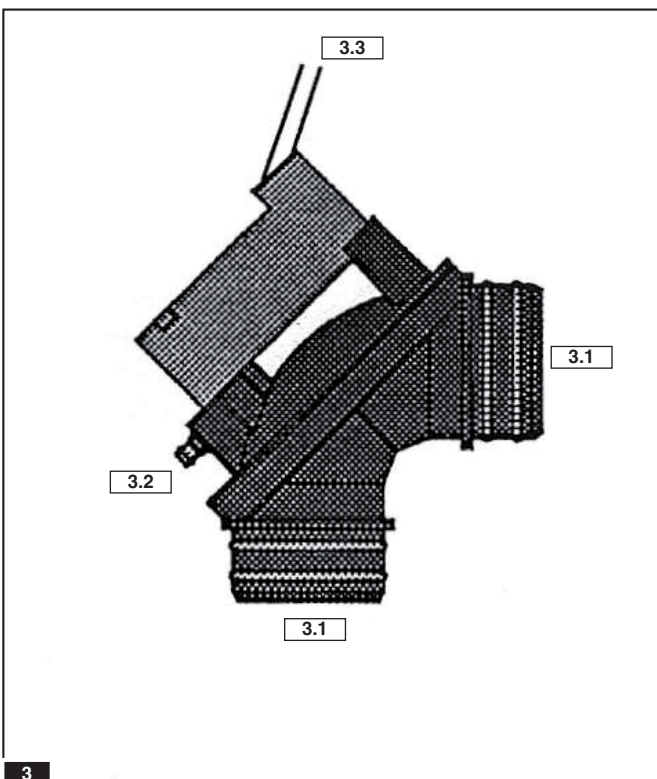

Assembly

5. Assembly

The installation of the external suction stream valve may exclusively be carried out by authorized engineers.

The relevant safety and inspection guidelines as well as the manufacturer's regulations must be observed!

4 See picture

Installation site: In the suction tube from the spittoon or in the floor box (Pos. **4.1**)

Fitting position: Any (take care that no water can run into the suction stream at the vacuum delivery!)

Electrical connection: Suction stream signal 24 V DC (For 24 V AC signal use the optionally available rectifier!) Attention! Mount connection cable without tension, because suction tubes can get shorter during pressurization.

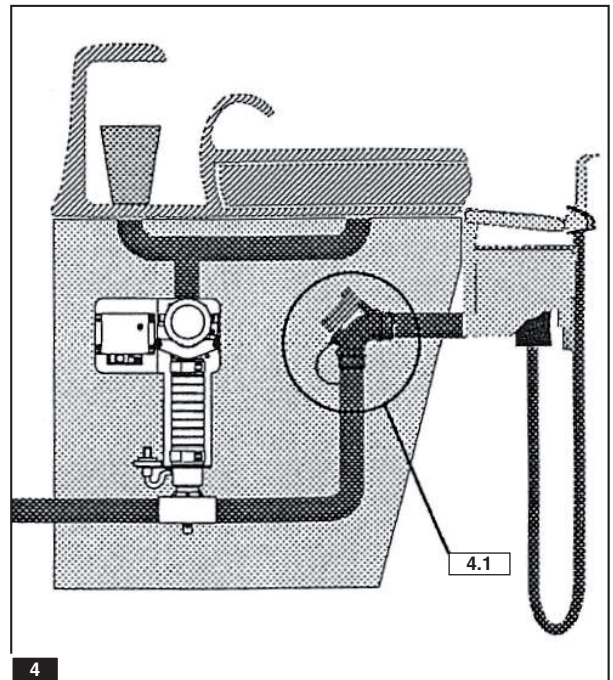

6. Accessories

Order No: 40050021 Accessories kit (optional)

Terminal strip (instead of plug mounted on the solenoid valve)

PVC-tube $\varnothing 2 \times 1$ mm (control air connection)

Tube connection $\varnothing 25$ mm / 45° (connection to the tube holder)

Tube connection $\varnothing 25$ mm / 45° with control air connection (to the suction motor)"

Order No: 40050027 Rectifier 24 V (optional)

7. Spare parts

In case of repairs only original parts may be used, as warranty expires otherwise!

5 See picture

5.1 O-ring $\varnothing 23 \times 1.5$ mm (10 pcs. package; Order No. 50110014)

5.2 Solenoid valve (1 pc. package; Order No. 50120001)

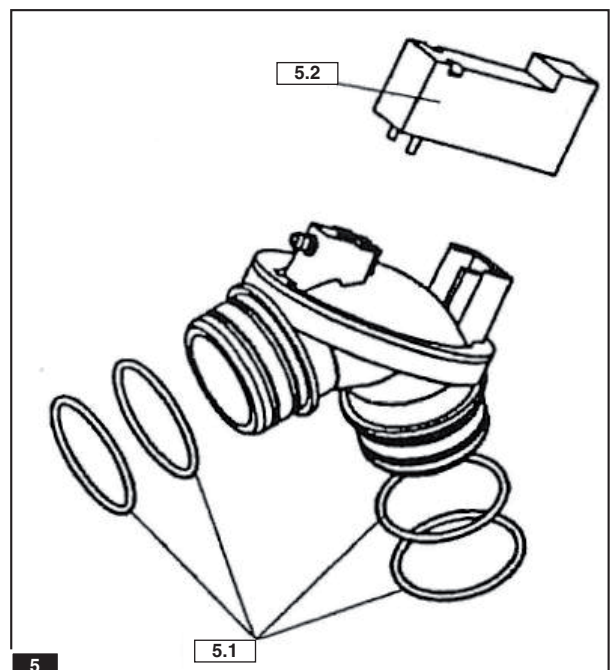

8. Cleaning and disinfection

6 and **7** See pictures

For cleaning and disinfection of the suction system and the spittoon bowl we recommend GREEN&CLEAN M2.

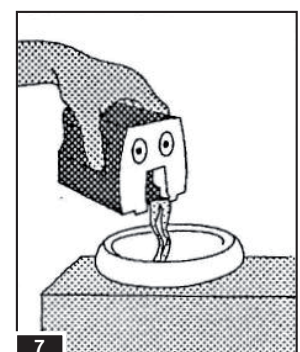
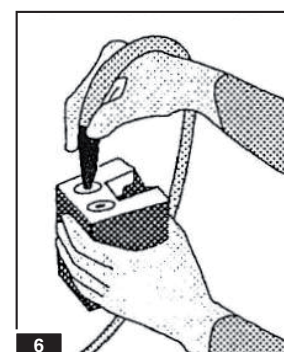



Austria

METASYS

Medizintechnik GmbH
Florianstraße 3
A-6063 Rum bei Innsbruck
☎ +43 / (0) 512 / 20 54 20-0
☎ +43 / (0) 512 / 20 54 20-7

Germany

METASYS

Medizintechnik GmbH
Ahornstraße 19
D-85614 Kirchseeon
☎ +49 / 2236 / 37 42 42
☎ +49 / 2236 / 37 42 41

France

METASYS France S.a.r.l.
9, bd E. Michelet
F-69008 Lyon
☎ +33 / (0) 4 / 37 90 22 15
☎ +33 / (0) 4 / 37 90 22 47
e-mail: info@metasys.fr
<http://www.metasys.fr>

email: info@metasys.com

<http://www.metasys.com>

Italy



METASYS GROUP

DENTAL ECO SERVICE ITALIA S.R.L.
Florianstraße 3
A-6063 Rum bei Innsbruck
☎ +39 / 045 / 98 144 77
☎ +39 / 045 / 98 144 75
email: desitalia@metasys.com

Ihr METASYS Berater: / Your METASYS agent: