

METASYS

GB

Amalgam separator ECONOMY SYSTEM TYPE 2 ECO II

Installation, operation and maintenance



Index

Explanation of the pictograms

The footnote found on each page defines the user group particular information is aimed at.

1. Index:

| | Page |
|--|------|
| 1. Index | 2 |
| 2. Explanation of the pictograms | 2 |
| 3. General information | 3 |
| 4. Application | 3 |
| 5. Construction | 3 |
| 6. Explanation of the type plate | 4 |
| 7. Technical data | 4 |
| 8. Installation options | 5 |
| 9. Guidelines for installation | 5 |
| 10. Hose connections | 5 |
| 11. Exchanging the collection container | 6 |
| 12. Maintenance, cleaning and disinfection | 7 |

2. Explanation of the pictograms:



Warning that to ignore the following instructions could lead to personal injury, disrupt operation or damage the apparatus!



means that particular attention is drawn to an important situation for the operating personnel or the technician.

General information

Application and construction

3. General information:



METASYS guarantees the safety, reliability and performance of the device only if the following instructions are followed:

- Only authorized experts should carry out installation, modifications or repairs.
- The appliance must exclusively be used in conformity with the instructions for installation, operation and maintenance.
- Use only genuine and original parts for repairs or replacements.
- Certificates of recycling for the amalgam waste (provided by the recycling company) must be kept in accordance with national regulations.
- *When requested by an authorized engineer, METASYS agrees to make all documents available for the use of technically qualified service personnel.*
- METASYS accepts no responsibility for damages caused due to external factors, such as wrong installation, improper use of the apparatus or unauthorized technical intervention.
- Duplication and distribution of this document may only be undertaken after prior permission from METASYS.

4. Application:

ECONOMY SYSTEM TYPE 2 (ECO II) is a sedimentation amalgam separator for the installation after a central suction system or in the waste water pipe of the dental unit.

5. Construction:

ECONOMY SYSTEM TYPE 2 combines the amalgam separator and the collector tank in one.

This means that once the device is completely filled with amalgam waste, the entire ECONOMY SYSTEM TYPE 2 is replaced.

Explanation of the type plate

Technical data

6. Explanation of the type plate:

1 See illustration

The type plate is located directly on the front side of the amalgam separator.

1.1 Equipment type

1.2 Serial number

1.3 Manufacturer's address

1.4 Max. suction volume

1.5 Max. water flow rate

7. Technical data

| | |
|------------------------------|---|
| Low pressure range: | 50 mbar - 300 mbar |
| Separation rate: | >99% in accordance with ISO 11143 |
| Collection container volume: | 0,4 gallons (1,5 litres) 4,5 pound (ca. 2kg) - 0,18 gallons (700ml) amalgam wastes |
| Max. ambient temperature: | 158° Fahrenheit |
| Possible suction systems: | wet or dry |
| Max. air flow | 400 gal/min, 1514l/min |
| Max. water flow rate: | 0,264 gal/min, 1 l/min |
| Dimensions (H x W x D): | 12,2 x 7,7 x 8,4 inches (309 x 196 x 213 mm) |
| Exchange interval: | approx. 12 months |

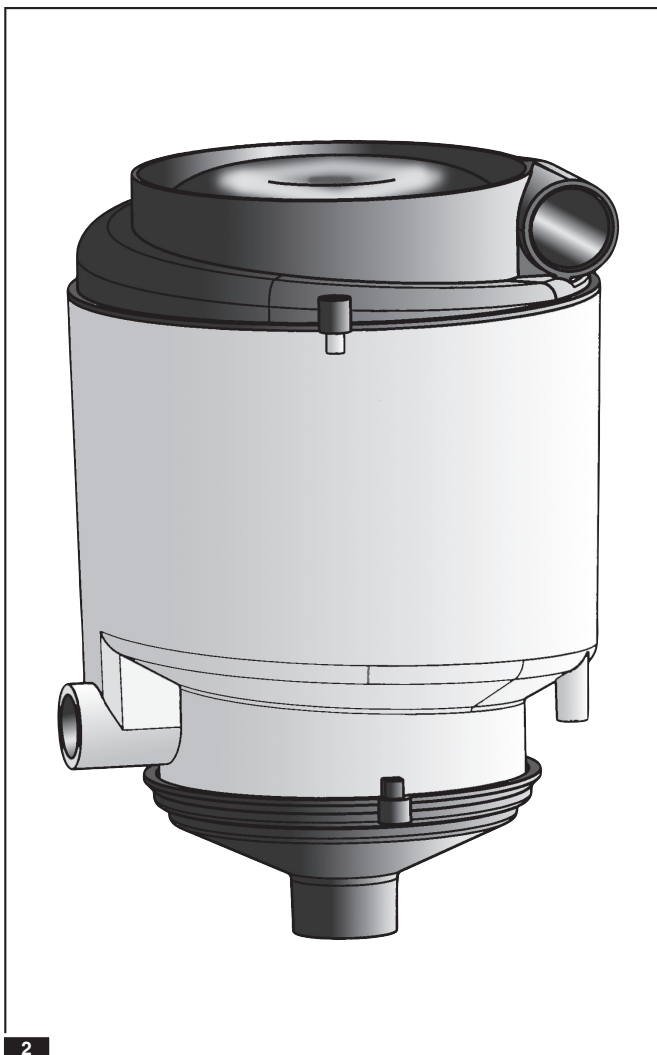
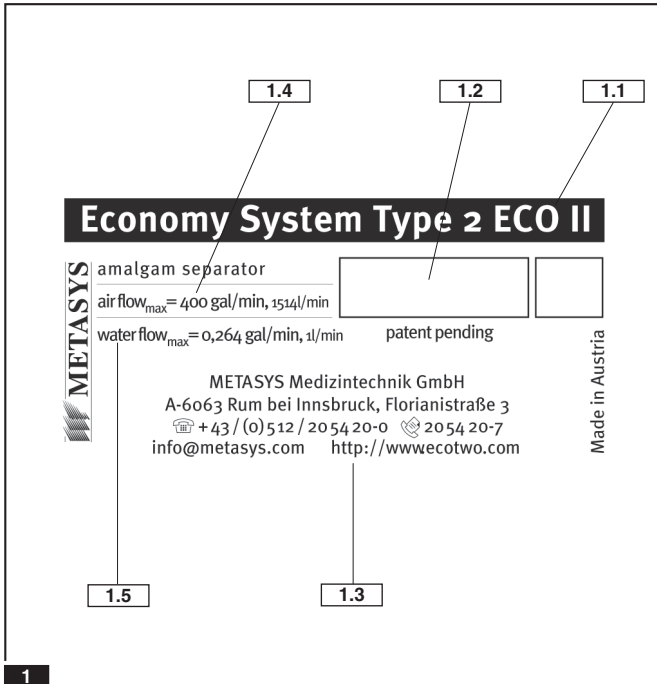

Installation options

Guidelines for installation

8. Installation options:

The ECONOMY SYSTEM TYPE 2 allows a variety of different installation options.

3 Installation before the suction machine:

If a wet suction machine is used, the device can be installed at any suitable position between the dental unit and the suction machine.

4 Installation directly into the waste water pipe of the dental units:

If a dry suction machine is used, the device is installed after the air/water water separation **4.1** directly into the waste water pipe of the dental unit.

Order option:

If the separator is installed in the treatment room, the ECO II can be fitted in a shapely housing.

9. Guidelines for installation:

5 Mounting element / wall bracket:

Slide the two mounting elements together as in the picture.

6 Fixing:

Screw together at the marked spots with the supplied screws and screw nuts.

7 For the mounting, the following minimal space is required:

H x W x D: 14,2 x 7,9 x 9 inches (360 x 200 x 230 mm)

The readily assembled mounting element has to be fixed on a suitable place on the wall using appropriate screws **7.1**. Position the device on the guiding studs of the mounting element and fasten with screws **7.2**.

Care must be taken that the mounting element is positioned vertically above the level of the suction machine. It is also possible to mount the bracket on an even floor space.

10. Hose connections:

8 See illustration

8.1 Waste water inlet

8.2 Waste water outlet

In order to guarantee a trouble-free connection of different sizes of hoses, hose adapters supplied along with the device must be inserted in the inlet and outlet openings.

In any case ensure that all connections are properly secured!

► Filling level

9 See illustration

A label **9.1**, which shows the filling level (100%, 95%) can be found on the ECO II. The label enables the user to monitor the filling level. When the amalgam waste has reached the maximum filling level **9.2**, contact your dental depot for a replacement of the collection container.

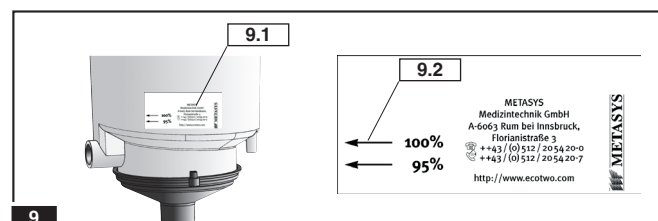
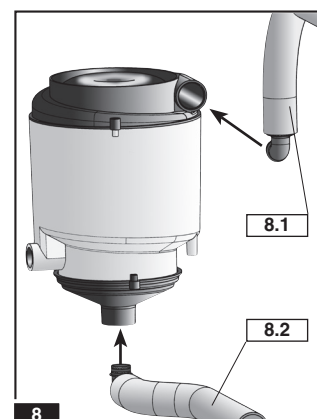
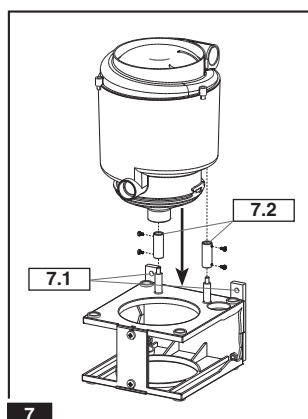
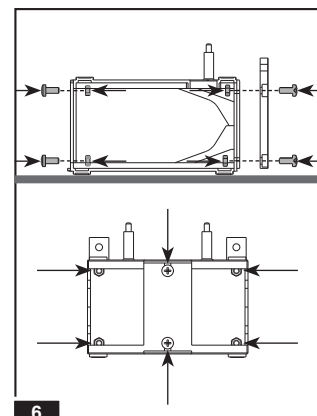
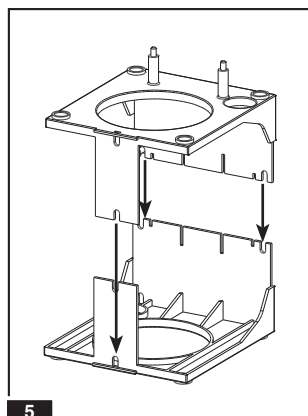
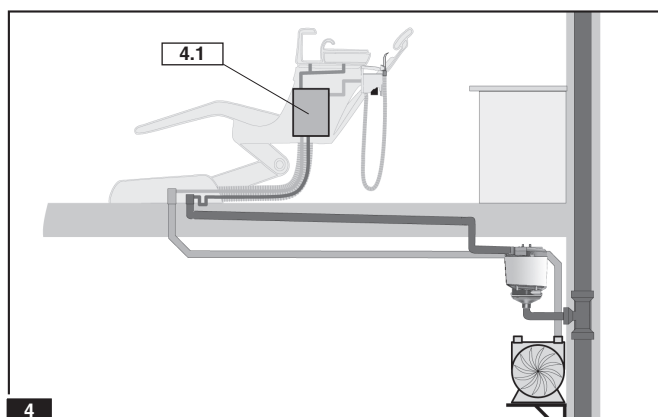
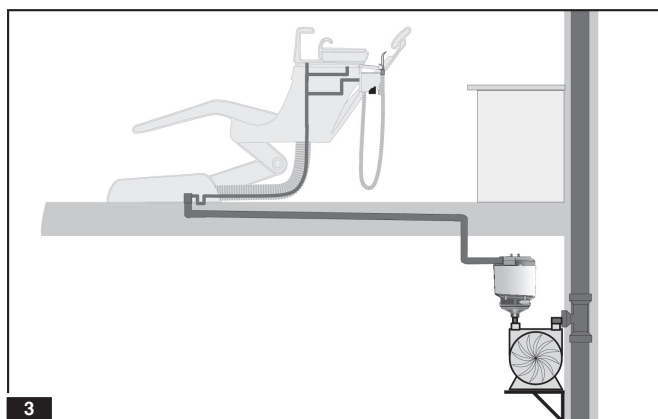

Exchanging the collection container

11. Exchanging the collection container:

As soon as the contents of the collection container have reached the maximum filling level, the ECO II must be replaced.



It is not possible to open the ECO II and reuse it! Every attempt to open the amalgam separator results in the malfunction of the device. Moreover, the required separation rate will no longer be achieved!

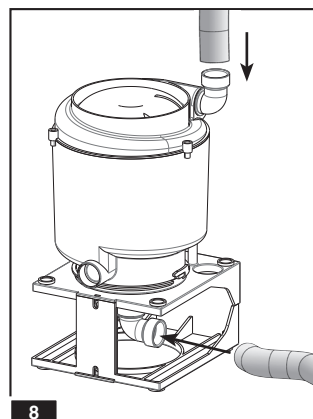
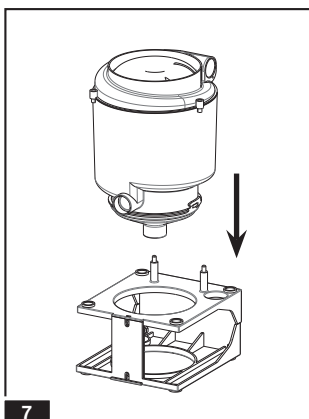
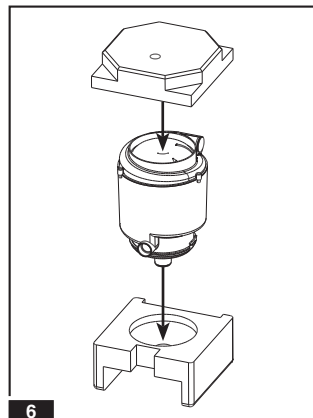
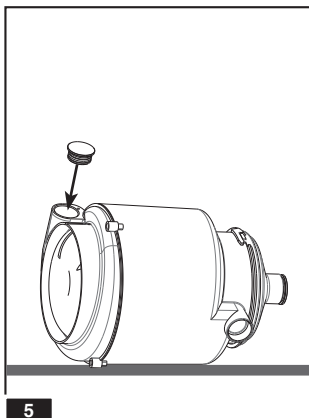
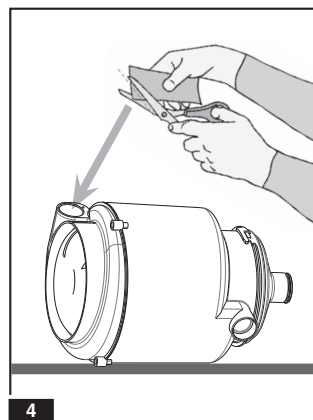
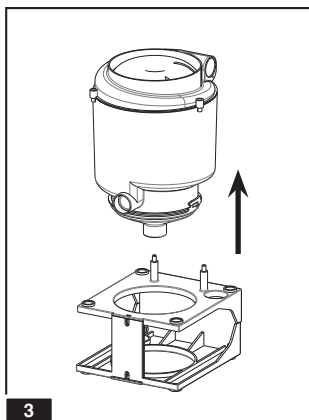
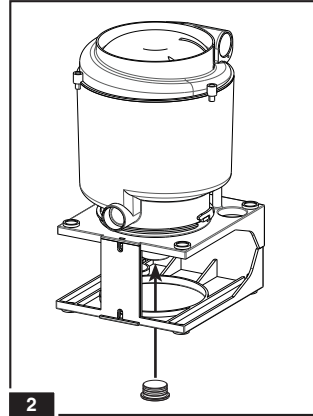
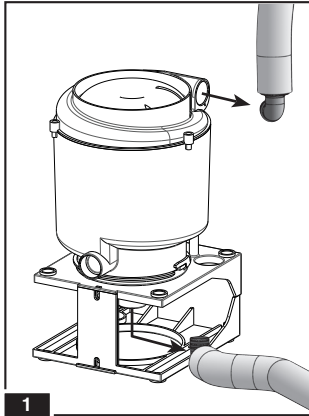

1 Remove the adapter with the tube at the waste water inlet and waste water outlet.

2 Tightly close the outlet of the full ECO II with the sealing plug (supplied with the amalgam separator).

3 Take out the ECO II from the bracket by lifting it off upwards.

4 Position the full ECO II horizontally onto an even surface, make sure that the inlet opening is pointing upwards! Cut open the disinfection pouch for final disinfection (supplied with new ECO II) at one corner and pour its content into the inlet opening of the full amalgam separator.

5 Afterwards also tightly close the inlet opening with the sealing plug.

6 Put the ECO II into the styrofoam shells, then place into the supplied cardboard box.

7 Install the new ECO II and secure it with the bolts and screws.

8 Reconnect the adapter with the tube to the "IN" and "OUT" openings.

► Suck in a large quantity of water – at least 0.5 gallons (2 liters) - to check the system for leakages. If leakages are found, check the hose connections.

► As agreed, METASYS will handle the disposal.

Maintenance, cleaning and disinfection with GREEN&CLEAN M2

12. Maintenance, cleaning and disinfection with GREEN&CLEAN M2:

9 See illustration:

Shortly operate the rinsing basin after every treatment!



10 See illustration:

Suck off some water with each of the suction tubes after every treatment!

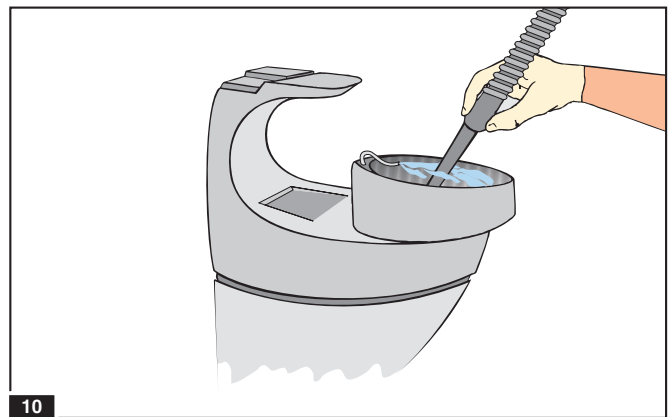

11 See illustration:

To ensure optimal functioning of the device and high material compatibility, use GREEN&CLEAN M2 for maintenance, cleaning and disinfection of the ECO II.

GREEN&CLEAN M2 should be used before longer periods of downtimes of the dental unit (e.g. lunch break, working day or holidays).

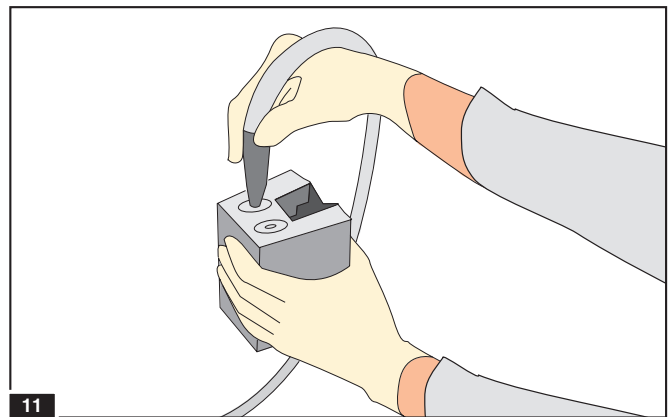

12 See illustration:

The spittoon bowl should also be rinsed with GREEN&CLEAN M2 twice a day.

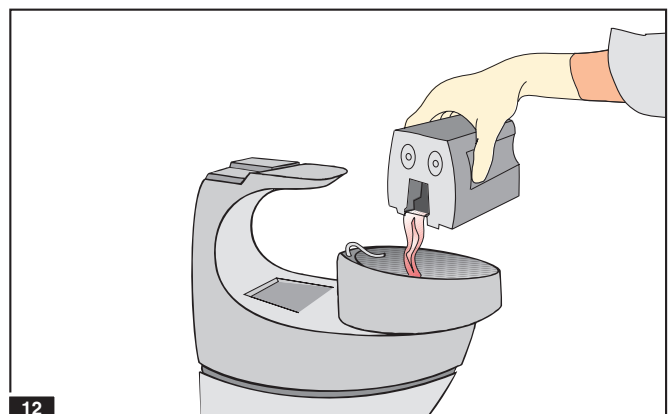



5001,
SW 74th Court, Suite 206
Miami, FL-33 1 55
☎ 1-877-METASYS
☎ 305 662 7479
email: metasysusa@aol.com
www.ecotwo.com

Your METASYS agent: